

# STAGE

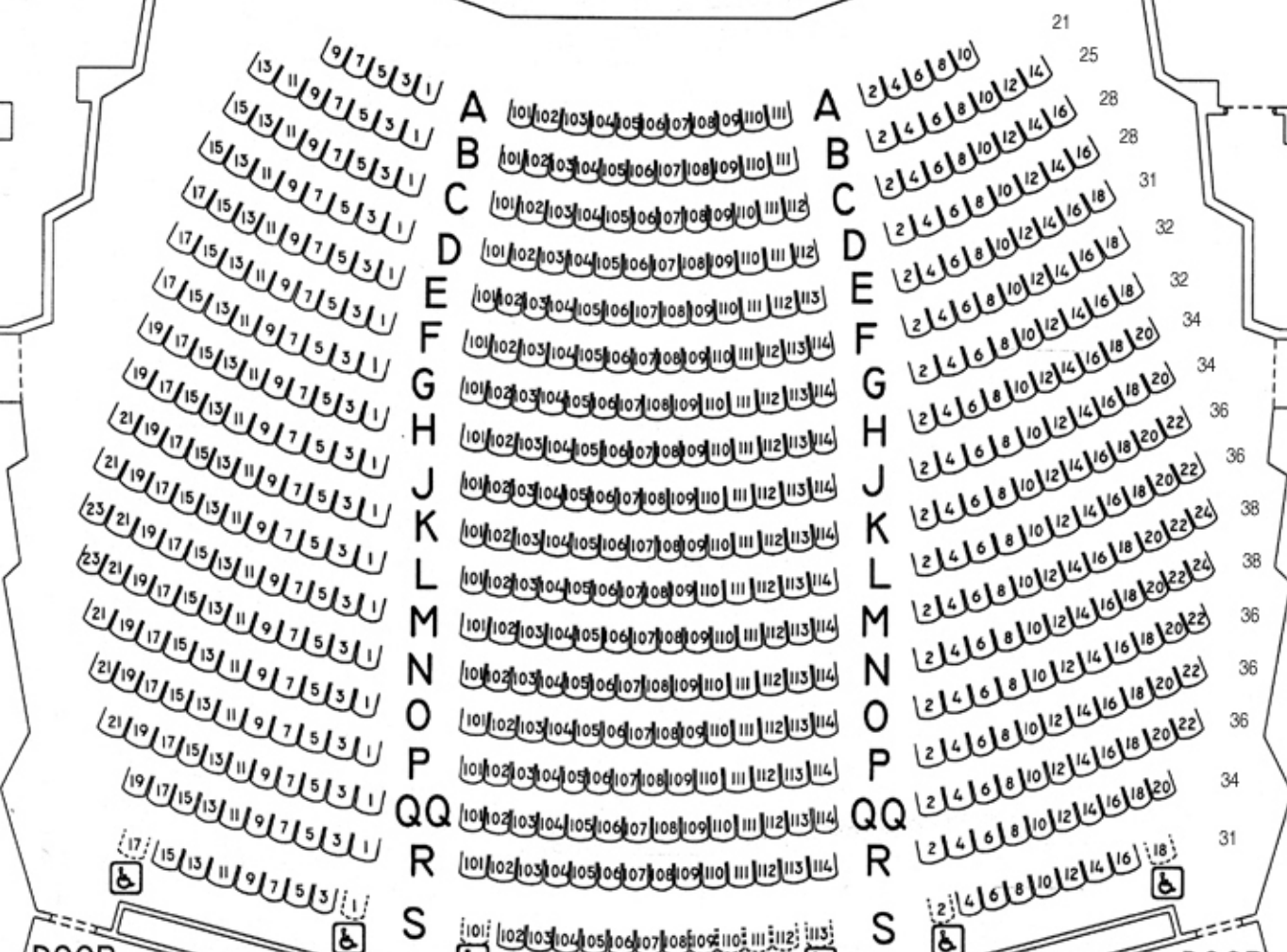

DOOR 1

DOOR 2

DOOR 3

DOOR 4

**IRVINE BARCLAY THEATRE  
CHENG HALL-MAIN FLOOR  
586 SEATS (6 REMOVABLE)**

Center Orchestra - 226 seats  
Left Orchestra - 180 seats  
Right Orchestra - 180 seats

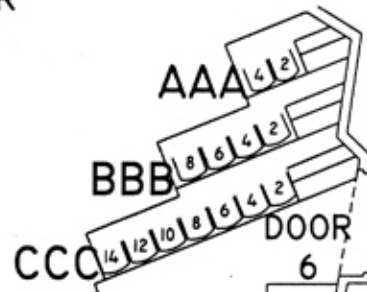
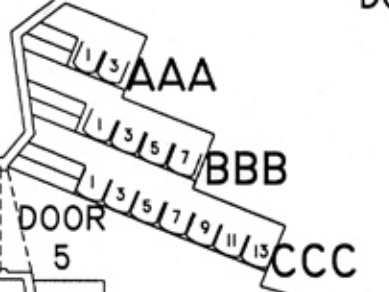

FIRST ROW OF BALCONY OVERHANGS  
MAIN FLOOR AT ROW P



**IRVINE BARCLAY THEATRE  
CHENG HALL-BALCONY  
170 SEATS**

Balcony Boxes - 13 seats each side  
Upper Balcony - 144 seats